

PLACE
SERIAL
NUMBER
LABEL
HERE

EXPAND-O-TURN LIGHT™

USER MANUAL

DOCUMENT ID: 70001

Have Questions?

We're here for you.



+1 866 543 8635
+1 704 847 2464



info@roni.com
www.roni.com



LIFT-O-FLEX

MOBI-Crane  Voyager



RONI, INC.
8001 Tower Point Drive
Charlotte, NC 28227 USA

BEFORE YOU BEGIN



READ

It is important that you read and understand this complete manual prior to using your LIFT-O-FLEX® ergonomic handling equipment. If you have any questions, contact your dealer or R on I, Inc.



+1 866 543 8635
+1 704 847 2464



info@roni.com
www.roni.com



8001 Tower Point Drive
Charlotte, NC 28227 USA

SPECIAL NOTES

The appearance of your LIFT-O-FLEX® lifter and the accompanying attachments may differ from the images displayed in this manual due to the custom nature of this equipment.

LIFT-O-FLEX® is a registered trademark of R on I, Inc., Charlotte, North Carolina.

“Where **Ergonomics** make
Economic sense.”

TABLE OF CONTENTS

1. DESCRIPTION	4
1.1 OVERVIEW	
1.2 COMPONENTS	
2. SAFETY	5
2.1 GENERAL	
2.2 STORAGE AND TRANSPORT	
2.3 MOVEMENT	
2.4 LOADING AND UNLOADING	
3. WARRANTY	6
4. USE	8
4.1 LOAD/ROTATE STANDING ROLLS	
4.2 LOAD ROLLS LAYING DOWN OR FROM A PRONG	
4.3 UNLOADING ROLLS	
4.4 UNLOAD STANDING ROLLS	
4.5 UNLOAD LAYING DOWN ROLLS	
4.6 ADJUSTMENT	
5. MAINTENANCE	11
5.1 EVERYDAY	
5.2 EVERY YEAR OR WHEN NEEDED	
5.3 PLATES AND DECALS	
5.4 SPARE PARTS	
6. TROUBLESHOOTING	13
7. TECHNICAL SPECIFICATIONS	13
8. DECLARATION OF CONFORMITY	15



1. DESCRIPTION

1.1 OVERVIEW

The Expand-O-Turn Light™ is designed to lift rolls by the core and then turn them, for example, to feed into machines. The roll is gripped in the core by the expander block, which uses the rolls own weight to grip. The expander can be set in two modes by using the setting pin; active mode for lifting and turning, and, inactive mode for unloading. The expander can handle rolls of different kinds, but the maximum load is limited by the length and weight of the roll.

1.2 COMPONENTS

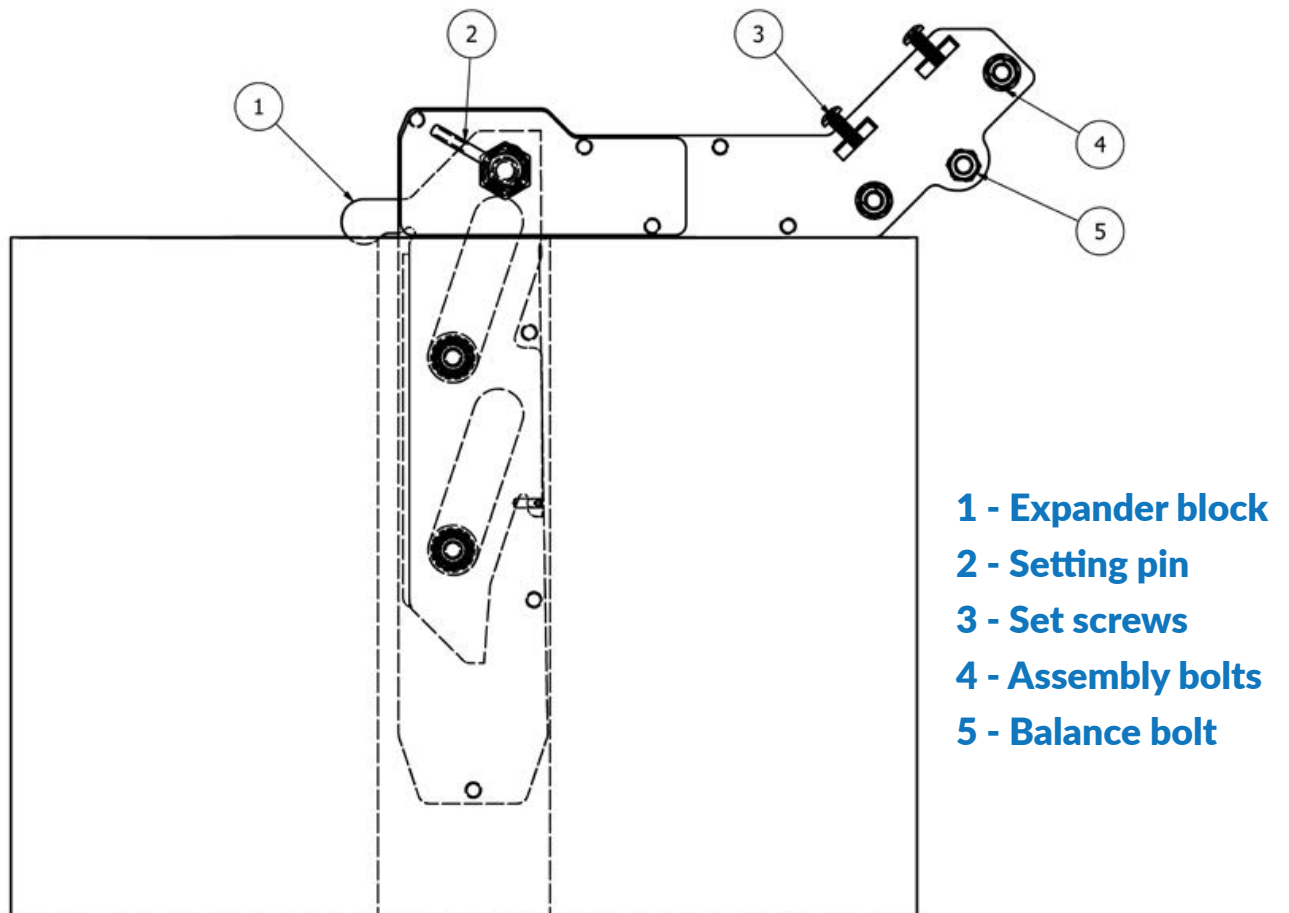

Overview of the expander and key parts

2. SAFETY

2.1 GENERAL

The operator should use the personal safety equipment (e.g. protective shoes) that handling the specific goods requires. Stated maximum load must not be exceeded. Be aware of the risk of crushing present between the attachment and the lifter legs or the floor when raising or lowering the load. Avoid putting hands or other parts of your body under the load.

2.2 STORAGE AND TRANSPORT

If the Expand-O-Turn Light™ is attached to a lifter when transported, the lifter should be carefully tied down to minimize the tipping risk. If the Expand-O-Turn Light™ is transported separately, it should be carefully packed to protect the expander.

2.3 MOVEMENT

The Expand-O-Turn Light™ should always be lowered to the lowest possible position before moving the lifter to have the safest and most stable handling possible. Be cautious when passing thresholds, cables, and other objects on the floor.

2.4 LOADING AND UNLOADING

The operator is responsible for the correct use of the Expand-O-Turn Light™. Do not place any hands or feet under a rotating load. Always rotate in the direction away from you.



3. WARRANTY

Limited Warranty

R on I, Inc. warrants this product to be free of defects in material and workmanship during the warranty period. Our warranty obligation is to provide a replacement for a defective original part if the part is covered by the warranty, after we receive a proper request from the warrantee (you) for warranty service.

Who may request service?

Only a warrantee may request service. You are the warrantee if you purchased the product from R on I, Inc. or from an authorized distributor and R on I, Inc. has been fully paid.

What is an “original part”?

An original part is a part used to make the product as shipped to the warrantee.

What is a “proper request”?

A request for warranty service is proper if R on I, Inc. receives: 1) a photocopy of the customer invoice that displays the shipping date; and, 2) a written request for warranty service that includes your name and phone number. Requests may be sent using the following methods:

Mail

R on I, Inc.
8001 Tower Point Drive
Charlotte, NC 28227

Fax

Toll Free 1-866-543-9532
Direct 1-704-847-6739

Email

info@roni.com

What is covered under the warranty?

After R on I, Inc. receives your request for warranty service, an authorized representative will contact you to determine whether your claim is covered by the warranty. Before providing warranty service, R on I, Inc. may require you to send the entire product, or just the defective part(s) to its facility in Charlotte, North Carolina.

How long is the warranty period?

The warranty period for original dynamic components is one (1) year. For batteries, the warranty period is 30 days. The warranty period begins on the date when R on I, Inc. ships the product to the warrantee.



Warranty Evaluation

All parts sent back (freight paid by customer) to R on I for warranty replacement and/or repair will be evaluated. R on I will determine if the part is a warranty issue or if it has been damaged due to misuse or negligence. A written report will be issued detailing the investigation of the part and whether or not the part is classified as warranty.

What is not covered by this warranty?

1. Labor
2. Freight
3. Occurrence of any of the following, which will automatically void the warranty:
 - product misuse
 - negligent operation or repair
 - corrosion or use in corrosive environments
 - inadequate or improper maintenance
 - damage sustained during shipping
 - collisions or other incidental contacts causing damage to the product
 - unauthorized modifications: do not modify the product in any way without first receiving written authorization from R on I, Inc. as modifications(s) might make the product unsafe to use or could potentially cause excessive and/or abnormal wear

If a defective part is warranted, how will R on I, Inc. correct the problem?

R on I, Inc. will provide an appropriate replacement for any covered part. An authorized representative of R on I, Inc. will contact you to discuss your claim.

Warranty Procedure

In the event that a part is damaged, broken, or just plain does not work, please contact R on I via phone or email to establish a dialogue to identify and diagnose the problem. Please have your lifter serial number available when you call or email?

(on the motor cover underneath the intermediate)

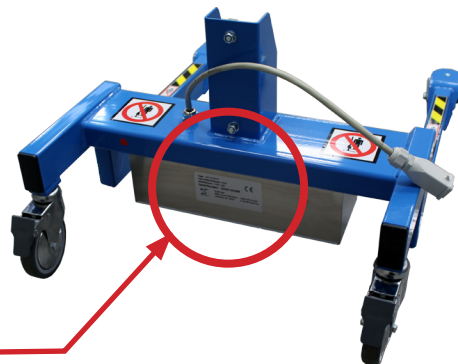

4. USE

The Expand-O-Turn Light™ is designed for roll handling only. In order to load a roll onto the expander, the setting pin needs to be set in green or “active mode”.

4.1 LOAD/ROTATE STANDING ROLLS

Turn the setting pin to green, or, “active mode”. Active mode can also be set after the expander core is inside the roll.

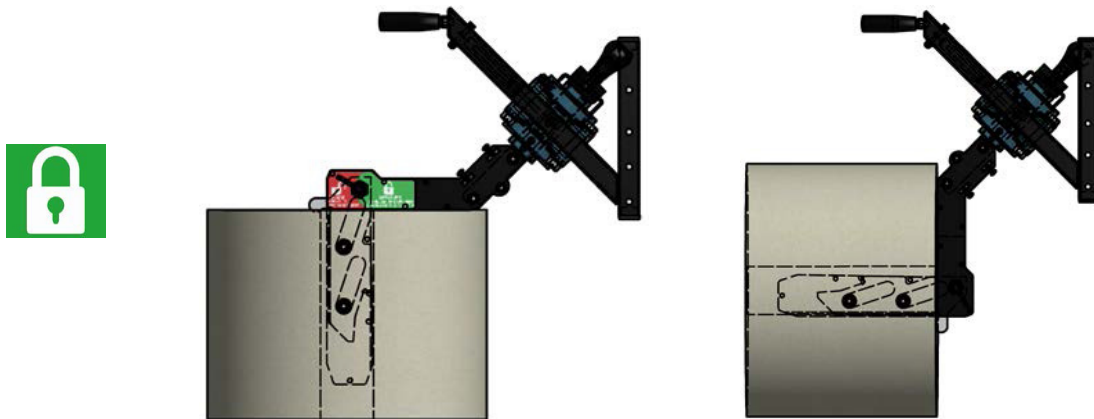

The expander block will now slide out from the expander. Position the tool above the roll and descend into the core. The LIFT-O-FLEX® slipping clutch will prevent the tool from being lowered too far. When the expander is being lowered, the expander block will slide back but instantly lock the roll if moving upwards. When the expander is fully descended into the core, the roll can be lifted and turned. Use the two handles when rotating. If the roll is turned from standing to laying, a safety pin will activate when reaching the end position. The safety pin prevents the expander from turning unintentionally during transport. Pull the safety pin to turn the roll back to standing.



4.2 LOAD ROLLS LAYING DOWN OR FROM A PRONG

Turn the setting pin to green, or, “active mode”. Active mode can also be set after the expender core is inside the roll.



Position the expander to the prong or the core of the roll and activate the brakes on the lifter. Slide the roll onto the expander completely. The expander block will slide back but instantly lock the roll when rotated.

Notice! - Do not place any hands or feet under a rotating load. Always rotate in the direction away from you.



4.3 UNLOADING ROLLS

To unload a roll, the setting pin needs to be set to red, or, “inactive mode”. This can be done if the roll is pushed in all the way on the expander pressing the expander block back or if the expander block is pulled back by hand.

4.4 UNLOAD STANDING ROLLS

Lower the roll onto a surface. Continue to lower the expander until the expander block is in its end position. The LIFT-O-FLEX® slipping clutch will prevent the tool from being lowered too far. Turn the setting pin to red, or, “inactive mode”; this will prevent the expander from sliding out.



If the roll is too short, the expander block needs to be pulled back by hand. Pull the block all the way back and then turn the setting pin to red, or, “inactive mode”. The expander can now be removed using the lifter controls.

4.5 UNLOAD LAYING DOWN ROLLS

Position the expander to the prong or the roll to the surface and activate the brakes on the lifter. Make sure that the roll is pushing the expander block all the way back. Turn the setting pin to red, or, “inactive mode”; this will prevent the expander block from sliding out. Slide the roll off the expander by hand onto the prong or by moving the lifter when unloading on a surface.



4.6 ADJUSTMENT

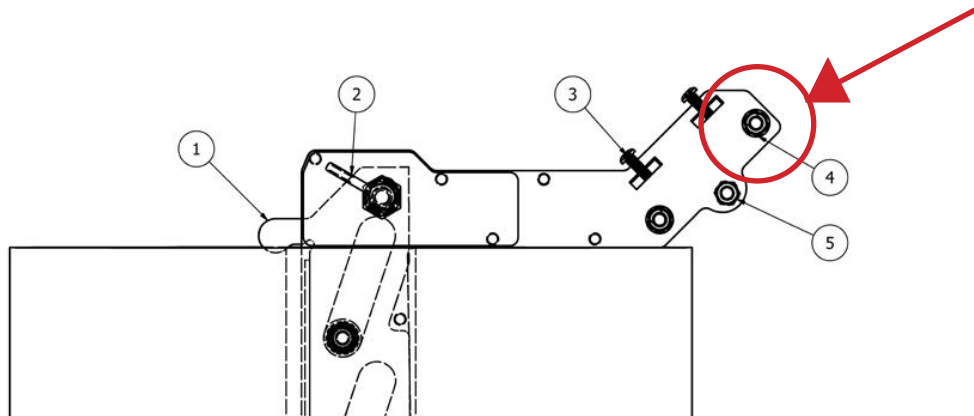

The expander can be adjusted to compensate for the weight of the roll and/or the circumstances around loading and unloading. This is done by loosening the assembly bolts (see drawing in description). Do not remove the bolts! Adjust the angle using the set screws and then tighten the bolts and nuts.

5. MAINTENANCE

In order for the equipment to function properly, it is important that maintenance is carried out in accordance with what is described below.

5.1 EVERYDAY

Wipe the Expand-O-Turn Light™ clean if it is dirty. Do not use water or pressure washers. Check the expander block and make sure it slides out of the core when activated.

5.2 EVERY YEAR OR WHEN NEEDED

Check the screws holding the Expand-O-Turn Light™ onto the lifter.

Check the locking nuts on the expander itself. The two nuts securing the expander block should not be tightened hard, but make sure the bolts go through the nuts.

Look for any damage or wear to the components.



5.3 PLATES AND DECALS

Verify that the following plates and decals are attached and fully readable.

Plate / Decal	Description	Placement
Unit Designation	Decal with serial number	One decal on the top of the unit
Instruction Decal	Decal instructing the operator	One decal on top of the handle and one on the side of the expander core
Max Load Decal	Max load of the Expand-O-Turn Light™	One decal on the top of the unit

5.4 SPARE PARTS

Only spare parts supplied or approved by R on I, Inc. may be used.

Commonly Ordered Spare Parts

Part Number	Description
17940-05	Expander block (with rubber)
17940-10	Spring for expander block

For other spare parts, please contact your dealer or R on I, Inc.

Contact us to order!

1-866-LIFT-O-FLEX (543-8635)
spareparts@roni.com



6. TROUBLESHOOTING

If the actual gripping mechanism fails, make sure no dirt or object interferes with the movement of the expander block. Make sure the spring moving the expander block is in place and works properly.

For any other troubles, see the manual for your LIFT-O-FLEX® lifter.

If the attachment is faulty or damaged, please contact your dealer or R on I, Inc.

7. TECHNICAL SPECIFICATIONS

Maximum load is determined by the roll measurements and weight. Maximum roll weight is 90 pounds. The diagram below explains the relationship between the roll weight and length.

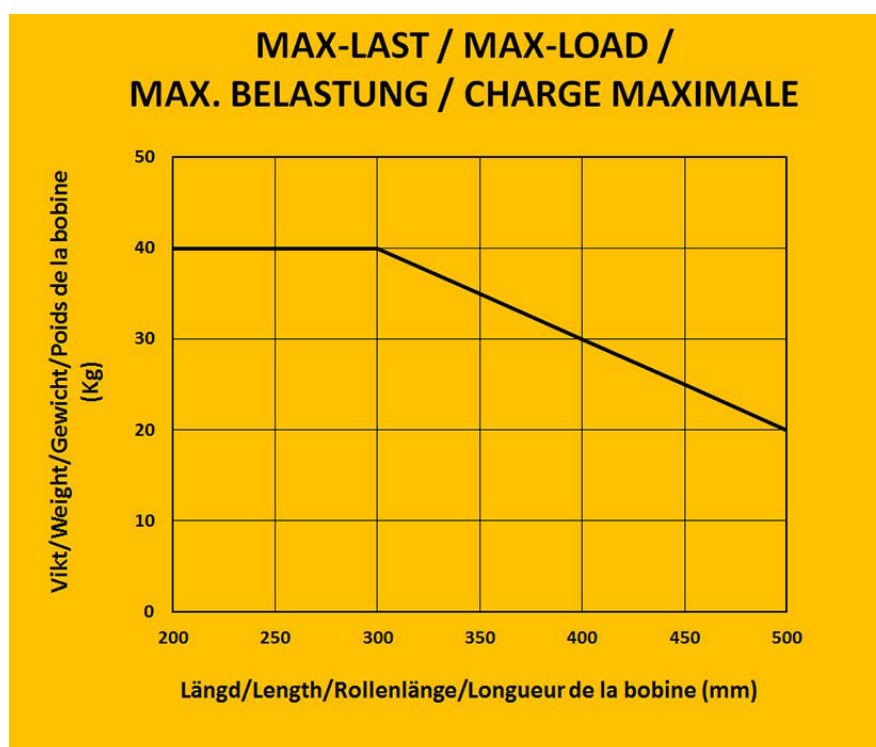

EXPAND-O-TURN LIGHT™	
Noise Level	Noise level not exceeding 70 dB(A)
Vibrations	Not to exceed 8 ft/s ²

For additional technical data, see your LIFT-O-FLEX® lifter manual.



NOTES

8. DECLARATION OF CONFORMITY

Manufacturer	Pronomic AB Box 5504 192 05 Sollentuna Sweden
Model	EXPAND-O-TURN LIGHT™
Serial Number	
Static load test	

Authorized to compile the technical file	Samuel Pierre, Pronomic AB, BOX 5504, 192 05 Sollentuna, Sweden
--	---

Applied EC directives:

2006/42/EG	Machinery Directive
2004/108/EG	EMC Directive

Applied standards:

SS-EN ISO 12100:2010	Safety of machinery - General principles for design - Risk assessment and risk reduction
SS-EN 349+A1:2008	Safety of machinery - Minimum gaps to avoid crushing of parts of the human body

We hereby declare that the above-referenced machine, built and equipped with attachments included in this manual, is in conformity with the applicable conditions state in the directives and standards.

Sollentuna, 2015-01-20



Joakim Stannow, Pronomic AB





LIFT-O-FLEX

MOBI-Crane

 **inovomech**

 **Voyager**

R ON I, INC.

8001 Tower Point Drive
Charlotte, NC 28227
USA

+1 866 543 8635

info@roni.com

www.roni.com

R on I reserves the right to change this information without further notice and holds no liability for printing errors in this content.

Copyright © 2016 R on I, Inc. All Rights Reserved.